

5

Getting Ready to Build (continued...)

LEVELING BUILD PLATFORM

1. Tap "Level" on your Dremel 3D40's touch screen.
2. 3D40 will first check the level at the back of the build platform, then move to the first leveling position.
3. The touchscreen will indicate if your build platform is too high or too low.
 - a) If the build platform is too high, turn knob to the right until you hear a "beep". Tap "Verify" to check the bed level again.
 - b) If the build platform is too low, turn knob to the left until you hear a "beep". Tap "Verify" to check the bed level again.
4. Repeat step above for the second levelling position.
5. When the build platform is level, extruder will automatically move to the calibration position and complete the levelling process.

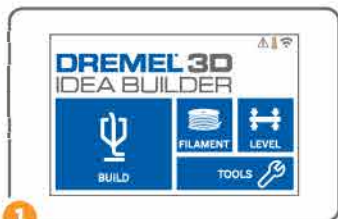

1



3

6

Building

BUILDING OUT OF THE BOX

1. On the main screen, tap the "Build" option. Then tap the machine icon to select from pre-installed models.
2. Tap on the model file you would like to build and tap "Build".
3. Your Dremel 3D40 will align the extruder with the build platform and will begin heating the extruder.
4. Once the correct temperature is reached, your model will begin to build.
5. Touch screen will display "Object Finished".

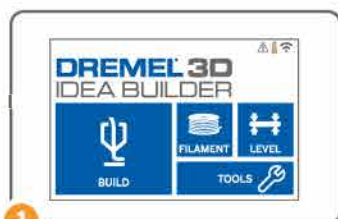

1



2

REMOVING YOUR OBJECT FROM THE BUILD PLATFORM

6. Wait for the extruder to cool before removing your object.
7. With the object still attached, remove build platform from the build area.
8. Use your hand to peel your object from the build platform. If needed, gently use the object removal tool to remove object from build platform.

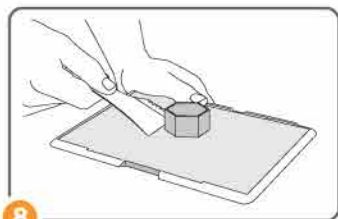

8

7

Best Practices & Resources

BEST PRACTICES

1. ALWAYS USE BUILD TAPE.
2. Ensure your platform is level (before you begin building your object).
3. Ensure spool is installed properly and can rotate freely.
4. When loading filament, allow Dremel 3D40 to extrude until material is consistent with the installed filament color.
5. It is important to stay near your Dremel 3D40 during operation and watch the Dremel 3D40 begin building objects. (If a situation occurs, select the STOP icon right away, to stop any further building).
6. Remove the build platform before removing the object.
7. Use object removal tool gently to avoid damaging the build platform or object.

OPERATING ENVIRONMENT

Room Temperature: 16-29° C (60 - 85° F)

Level workspace

Dry workspace environment

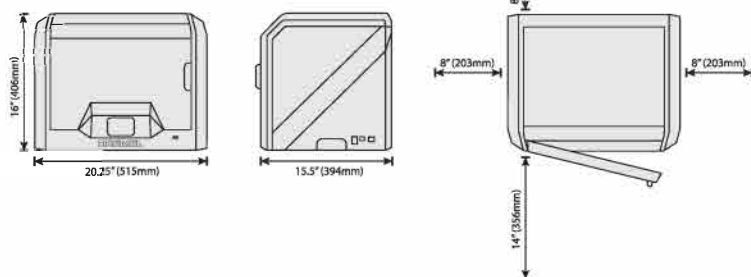

3D40 RESOURCES

Quick Start Guide	In box and www.dremel3d.com
3D40 Website	www.dremel3d.com
3D40 Customer Support	1-844-4DRML3D (1-844-437-6533) www.dremel3d.com
Print Studio Software	Installed from www.dremel3d.com or from USB flash drive provided with the Dremel 3D40

8

Get Connected

Wi-Fi

Connect your printer to your wireless network so you can build from anywhere.



MOBILE APP

Download the Dremel 3D Mobile App to control your 3D40 remotely, browse for new projects, and more.



DREMEL3D.COM

Visit Dremel3D to register your 3D40, sign up for the newsletter, and receive Dremel expert customer support.



Part#: 2610039152

SIDE 2